

The Symbol of Excellence



Industries Inc.



Shown with 10,000#
Drive-On Deck

High Density, Heavy Commercial Wet Pack Compactor and Container

Model WET-2 System

2 cu. yd. Stationary Compactor



Reduced Hauling Costs - Larger container and higher density packing increases payload and reduces waste hauling costs.

All of the convenience of a self-contained with the options and performance of a high density stationary compactor.

Meets or exceeds current ANSI Z245 safety standards for stationary compactors.

Forward Sloping Design - Liquid waste runs into the container reducing unsightly and offensive liquid discharge behind the ram and under the compactor.

Leak Resistant Container - Specially designed door seals with gasket and adjustable hinges contains up to 1,750 gallons of liquids.

Overhead Sealed Door - Spring hinged drop down door seals compactor opening to assure no leakage in transportation.

Large 49" x 57 1/2" Clear Top Opening - Allows loading of bulky items without having to spend additional hours breaking down materials.

Engineering services for system designs that meet your individualized needs.

American Made Product - We use only the finest American made electrical and hydraulic components specified for dependability, serviceability, and nationwide availability.

Out performs and outlasts all other stationary compactors in its class.

Industries Leading Warranty
Three Years Ram and Frame Weldment
One Year Electrical and Hydraulic Components
One Year Parts and Labor

We Build Equipment the Old Fashioned Way — "WITH PRIDE"

Compactor Model	Mfr's. Rating (cu. yds.)	WASTEC Type Rating (cu. yds.)	Clear Top Opening (in.)		Chamber Length (in.)	Ram Stroke (in.)	Ram Penetration (in.)	Force Rating (Ram PSI at stated forces lbs.)		Hydraulic Syst. Pressure PSI		Ram Face (in.)		Volume Displacement (cu. yds. per hr.)	Motor H.P.	Cycle Time (sec.)	Discharge Opening (in.)			Base Unit Weight (lbs.)
			Length	Width				Normal	Max.	Normal	Max	Width	Height				Width	Height	Frm Gnd	
Wet-216	2	1.5	49	57 1/2	50	74	24	50,900/36.9	56,500/40.9	1,800	2,000	60	23	109	10	49	61	23	19 3/8	7,300
WET-217	2	1.5	49	57 1/2	50	74	24	69,300/51.3	77,000/57.0	1,800	2,000	60	23	77	15	69	61	23	19 3/8	7,665
Wet-226	2	1.5	49	57 1/2	50	74	24	101,800/73.8	113,100/82.0	1,800	2,000	60	23	85	20	63	61	23	19 3/8	7,700

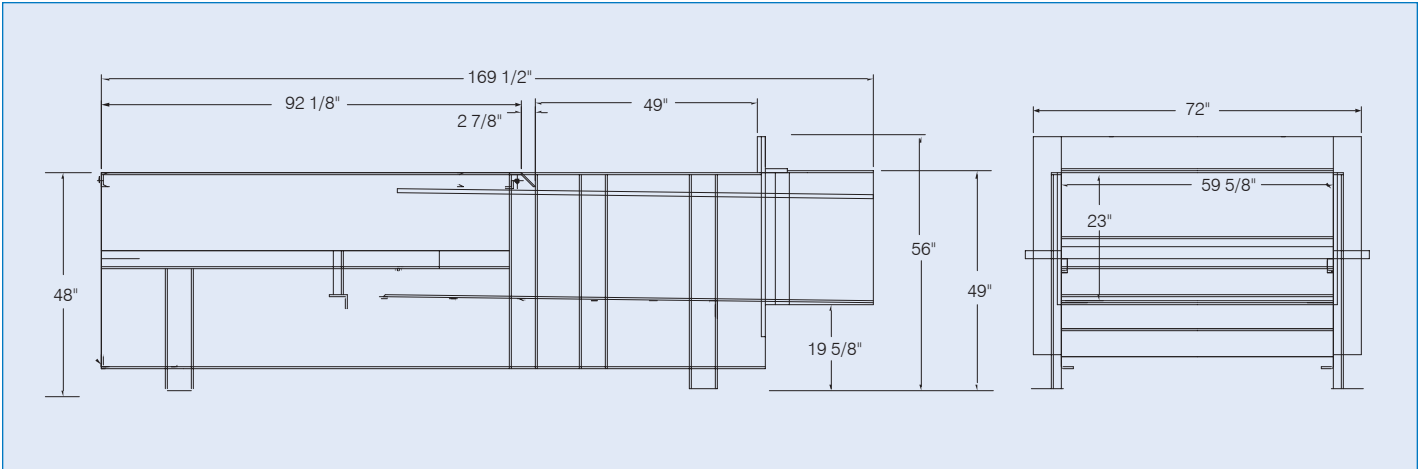

Compactor Standard Features

Frame:	Floor, Work Hardening Steel Plate	3/8"
	Floor Supports	C4" x 5.4#
	Side Plates	1/4"
	Side Reinforcements	C6" x 13#
Breaker Bar:		1-1/2" x 8"
	Weldment	1" x 5" Bar
Ram:	Face Plate	3/4"
	Floor Plate	1/2"
	Side Plate	7 GA.
	Top Plate	1/4"
	Top Supports	C4" x 5.4#
	Guides	Adjustable Nylatron Blocks
	Ram Hold Down Bars	1" x 1"
Cylinder:	Wet-216	6" Bore x 4.5" Rod x 74" Stroke
	Wet-217	7" Bore x 4-1/2" Rod x 74" Stroke
	Wet-226	(2) 6" Bore x 4.5" Rod x 74" Stroke
Motor:	Wet-216	10 H.P. 208 or 230/460 Volt 3 Phase
	Wet-217	15 H.P. 208 or 230/460 Volt 3 Phase
	Wet-226	25 H.P. 208 or 230/460 Volt 3 Phase

Pump:

Wet-216/217	16 GPM, Constant Displacement Vane Type
Wet-226	25 GPM, Constant Displacement Vane Type

Reservoir:

Wet-216/217	40 Gallon
Wet-226	75 Gallon

Remote Power unit

Oil- Suitable for a Wide Temperature Range

Oil Sight Gauge with Thermometer

UL Listed Electrical Components

Controls in Main Panel

Key Lock On/Off Switch

Emergency Mushroom Type Stop Button

Green Push to Start Button

Automatic Multi-cycle

Automatic Safety Retract

Automatic/Manual Selector Switch

Ram Position Switch

Full/Jam Automatic Shut-off with Indicator

Removable Rear Access Panels

Ratchet Binder/Hooks: 90,000# Capacity (160,000# on Wet-226)

Optional Features

Decks 750# & 10,000# Capacity

Safety handrails

Safety Gate w/Interlock

Side or Rear Load Hopper

Enclosed Hopper w/Door

Security Chute (Side or Rear)

Full Enclosure

Safety Interlock System

Deodorizer System

UL Certified Panel

Photo Electric Start System

Keyed Pinning/Boost Override System

Advance Full Load Indicator

TEFC Motor

Low/Hot Oil Indicator with Shut-off

Thermo Oil Heater

Power Unit Weather Cover

Container Guide

Through Wall Ratchet Kit

Automatic Monitor System



WASTE EQUIPMENT
TECHNOLOGY ASSOCIATION



ENVIRONMENTAL INDUSTRY
ASSOCIATIONS

CAUTION! This Equipment Should Be Operated By Properly Trained Personnel. Improper Use, Misuse or Lack of Maintenance could cause injury to people and/or property. Photos used in this brochure are illustrative only. Due to its commitment to quality, SP Industries' specifications are subject to change without notice to accommodate improvements to its equipment. Information contained within this literature is intended to be the most accurate available at the time of printing.

Distributed By:



SP INDUSTRIES, INC.

2982 Jefferson Rd.

Hopkins, MI 49328

www.sp-industries.com

Phone: 269-793-3232

Toll Free: 800-592-5959

Fax: 269-793-7451

E-mail: info@sp-industries.com